



Yuasa Technical Data Sheet

Yuasa YBX3641 - Super Heavy Duty Battery

Performance

Voltage	12V
Capacity (20-hour)	110Ah
Cold Cranking Amps (EN1)	925A

Dimensions

Length	329mm
Width	173mm
Height	240mm

Weights & Measures

Mean Weight with Acid	25kg
-----------------------	------



Container Features

Case Type	GR31S BCI
Cell Layout	9
Hold Down	N
State of Charge Indicator	✓
Handles	✓
Lid Type	SMF Double Lid

Technology

Flame Arrestor Technology	✓
Recommended Charge Rate	Ca/Ca 5A
Performance Marking	W3-C2-V3-E2

Terminal Type

Thread

US BCI stud terminal

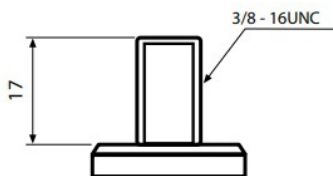

Cell Assembly Layout

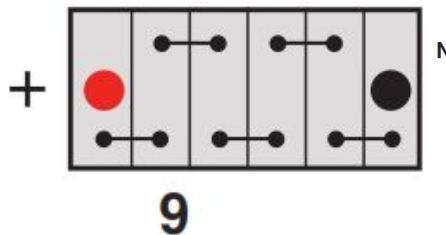

Battery Hold-down



Data Sheet generated on 05/11/2024 - E&OE